

VHM K10-K30	30°	HSC
Al-X Coating	R	
HRc 60		

### Corner radius end mills

For steels, stainless steels, titanium alloy, prehardened steels and hardened steels up to 60 HRc

### Eckradiusfräser

Für Stählen, rostfreie Stählen, Titan, vergüteten Stählen und gehärteten Stählen bis 60 HRc

Example: Order code WR 230 010-02004

d-Code	d x R x H x D	L
--------	---------------	---



Wide-cut

P	HRc < 24	⊙
	HRc 24 - 35	⊙
	HRc > 35	⊙
H	HRc 45 - 55	⊙
	HRc 56 - 60	○
	HRc > 60	
M	Stainless steel	⊙
K	Cast iron	⊙
N	Copper alloy	○
S	Titanium alloy	⊙
	High-temperature alloy	○

<b>010-02004</b>	1.0 x R0.2 x 2.0 x C 4	50	●	◇
<b>015-02004</b>	1.5 x R0.2 x 3.0 x C 4	50	●	◇
<b>015-05004</b>	1.5 x R0.5 x 3.0 x C 4	50	◇	◇
<b>020-02004</b>	2.0 x R0.2 x 4.0 x C 4	50	●	●
<b>020-05004</b>	2.0 x R0.5 x 4.0 x C 4	50	●	●
<b>025-02004</b>	2.5 x R0.2 x 5.0 x C 4	50	●	●
<b>025-05004</b>	2.5 x R0.5 x 5.0 x C 4	50	●	●
<b>030-02004</b>	3.0 x R0.2 x 6.0 x C 4	50	●	●
<b>030-05004</b>	3.0 x R0.5 x 6.0 x C 4	50	●	●
<b>030-10004</b>	3.0 x R1.0 x 6.0 x C 4	50	◇	◇
<b>040-02004</b>	4.0 x R0.2 x 8.0 x C 4	50	●	●
<b>040-05004</b>	4.0 x R0.5 x 8.0 x C 4	50	●	●
<b>040-10004</b>	4.0 x R1.0 x 8.0 x C 4	50	◇	◇
<b>050-05006</b>	5.0 x R0.5 x 10.0 x C 6	50	◇	●
<b>050-10006</b>	5.0 x R1.0 x 10.0 x C 6	50	◇	●
<b>060-02006</b>	6.0 x R0.2 x 12.0 x C 6	50	◇	◇
<b>060-05006</b>	6.0 x R0.5 x 12.0 x C 6	50	◇	●
<b>060-10006</b>	6.0 x R1.0 x 12.0 x C 6	50	◇	●
<b>060-15006</b>	6.0 x R1.5 x 12.0 x C 6	50	◇	◇
<b>060-20006</b>	6.0 x R2.0 x 12.0 x C 6	50	◇	◇
<b>080-05008</b>	8.0 x R0.5 x 16.0 x C 8	60	◇	●
<b>080-10008</b>	8.0 x R1.0 x 16.0 x C 8	60	◇	●
<b>080-15008</b>	8.0 x R1.5 x 16.0 x C 8	60	◇	◇
<b>080-20008</b>	8.0 x R2.0 x 16.0 x C 8	60	◇	◇
<b>100-05010</b>	10.0 x R0.5 x 20.0 x C10	75	◇	●
<b>100-10010</b>	10.0 x R1.0 x 20.0 x C10	75	◇	●
<b>100-15010</b>	10.0 x R1.5 x 20.0 x C10	75	◇	◇
<b>100-20010</b>	10.0 x R2.0 x 20.0 x C10	75	◇	◇
<b>120-05012</b>	12.0 x R0.5 x 24.0 x C12	75	◇	●
<b>120-10012</b>	12.0 x R1.0 x 24.0 x C12	75	◇	●
<b>120-20012</b>	12.0 x R2.0 x 24.0 x C12	75	◇	◇
<b>120-30012</b>	12.0 x R3.0 x 24.0 x C12	75	◇	◇

Cutting data, P74 - P75

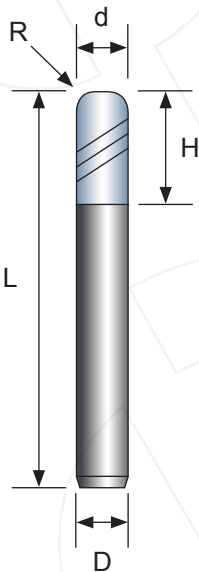

Tolerance / Toleranz

Range	Diameter
1 ≤ d < 8	0 / -0.02
8 ≤ d < 18	0 / -0.03